



Fisheries and Oceans
Canada

Pêches et Océans
Canada

Canadian
Coast Guard

Garde côtière
canadienne

NOTICES TO MARINERS PUBLICATION EASTERN EDITION

MONTHLY EDITION N°02
February 28, 2020



Safety First, Service Always

Published Monthly by the
CANADIAN COAST GUARD
www.notmar.gc.ca/subscribe

CONTENTS

	Page
Section 1	General and Safety Information..... 1 - 4
Section 2	Chart Corrections..... 5 - 17
Section 3	Radio Aids to Marine Navigation Corrections N/A
Section 4	Sailing Directions and Small Craft Guide Corrections..... 19 - 21
Section 5	List of Lights, Buoys and Fog Signals Corrections..... 22 - 23

Notices to Mariners Publication
Eastern Edition
Monthly Edition N°02/2020

Published under the authority of:
Canadian Coast Guard Programs
Aids to Navigation and Waterways
Fisheries and Oceans Canada
Montreal, Quebec
H2Y 2E7

© Her Majesty the Queen in Right of Canada, 2020
Fs152-5E-PDF
ISSN 1719-7678

Available on the Notices to Mariners website:
www.notmar.gc.ca

Disponible en français :
Publication des Avis aux navigateurs
Édition de l'Est
Édition mensuelle N°02/2020

EXPLANATORY NOTES

Geographical positions refer directly to the graduations of the largest scale Canadian Hydrographic chart unless otherwise indicated.

Bearings refer to the true compass and are measured clockwise from 000° (North) clockwise to 359°; those relating to lights are from seaward.

Visibility of lights is that in clear weather.

Depths - The units used for soundings (metres, fathoms or feet) are stated in the title of each chart.

Elevations are normally given above Higher High Water, Large Tide unless otherwise indicated.

Distances may be calculated as follows:

1 nautical mile = 1,852 metres (6,076.1 feet)

1 statute mile = 1,609.3 metres (5,280 feet)

1 metre = 3.28 feet

Temporary & Preliminary Notices are indicated by a (T) or a (P) in Section 1, respectively. Please note that Nautical charts are not amended by the Canadian Hydrographic Service for Temporary (T) and Preliminary (P) Notices. It is recommended that mariners chart these corrections in pencil. The list of charts affected by Temporary and Preliminary Notices are revised and promulgated quarterly in Section 1 of the Monthly Edition.

Please note that, in addition to the temporary and preliminary changes normally advertised as (T) and (P) Notices, there are a few permanent changes to aids to navigation that have been advertised as Preliminary Notices to Mariners while charts are being updated for new editions.

Marine Information Report & Suggestion Sheet

Mariners are requested to notify the responsible authorities when new or suspected dangers to navigation are discovered, changes observed in aids to navigation or corrections to publications are seen to be necessary. Such communications can be made using the *Marine Information Report & Suggestion Sheet* inserted on the last page of each monthly edition of *Notices to Mariners*.

Canadian Hydrographic Service – Information Published in Section 2 of *Notices to Mariners*

Mariners are advised that only the most critical changes that directly affect safety to navigation are issued in Section 2 – Chart Corrections. This limitation is required to ensure that charts remain as clear and easy to read as possible. As a result, mariners may see minor discrepancies of a non-critical nature between information in official publications. For example, a small change in the nominal range or focal height of a light may not result in the production of a chart correction in *Notices to Mariners*, but may result in a correction in the *List of Lights, Buoys and Fog Signals* publication.

In case of discrepancy between information provided on CHS charts relating to aids to navigation, and the *List of Lights, Buoys and Fog Signals* publication, the latter shall be deemed as containing the most up-to-date information.

Canadian Nautical Charts & Publications

A source list of Canadian nautical charts and publications is published in Notice No. 14 of the *Notices to Mariners Annual Edition 2020*. The source supply and the prices effective at the time of printing are listed. For current chart edition dates, please refer to the following website: www.chs-shc.gc.ca/charts-cartes/paper-papier/index-eng.asp

CHART CORRECTIONS – SECTION 2

Corrections to nautical charts will be listed in numerical order by chart number. Each chart correction listed applies only to that particular chart. Related charts, if any, will have their own specific correction listed separately.

Users should also refer to CHS *Chart 1: Symbols, Abbreviations and Terms* for additional information pertaining to the correction of charts.

The illustration below describes the elements that will comprise a typical Section 2 chart correction:

	Chart Number	Chart Title	Charts latest new edition date	Horizontal Chart Datum	Last Correction
Weekly chart correction date	1202	Cap Eternité à/to Saint-Fulgence – New Edition – 20-MAY-94 – NAD 1927			
	6-Aug-1999				LNM/D 23-Jul-1999
	Add	light Fl G			48°26'36.4"N 70°53'08.6"W
		(See Chart No 1 P24)		(F2007-107) LL (700) DFO(6829264-01)	
	Chart action	Chart No 1 reference no.	CCG reference no.	List of light no.	CHS reference no.

The last correction number is identified with the **LNM/D** or Last Notice to **Mariners** Number / Date.

NOTICES TO MARINERS WEBSITE – MONTHLY EDITIONS, CHART CORRECTIONS, AND CHART PATCHES

The Notices to Mariners website allows users to access the [monthly publications](#), [chart corrections](#), and [chart patches](#).

Users can subscribe for free to the [email notification service](#) to receive notifications when charts of interest are updated, including their patches, as well as when a new monthly edition becomes available online.

In addition, the monthly publication and related files to download, such as chart patches and *Sailing Directions* diagrams, can be obtained all together through the download of a single ZIP file.

ADVISORY NAVIGATIONAL WARNINGS / NOTICES TO SHIPPING

The Canadian Coast Guard is implementing a number of changes to the aids to navigation system in Canada.

These changes are advertised as Navigational Warnings, formerly called Notices to Shipping¹, that are broadcast by the Canadian Coast Guard, and are then followed up with Notices to Mariners, then charts are updated by hand correction, reprints or new editions.

Mariners are advised that all relevant Navigational Warnings (NAVWARNs) should be kept until superseded by Notices to Mariners or through revised charts issued by the Canadian Hydrographic Service (CHS).

Navigational Warnings are accessible on the applicable regional page on the Canadian Coast Guard e-Navigation Maritime Information Portal at <http://www.marinfo.gc.ca/e-nav>.

The Canadian Hydrographic Service is reviewing the impact of these changes with the Canadian Coast Guard and together are preparing an action plan on the issuing of chart revisions.

For further information, contact your regional Navigational Warning (NAVWARN) Issuing Desk.

Atlantic Region

* Port aux Basques MCTS Centre

Canadian Coast Guard
49 Stadium Rd.
P.O. Box 99
Port aux Basques, NL A0M 1C0

Telephone: (709) 695-2168 or 1-800-563-9089
Facsimile: (709) 695-7784

Email: NAVWARN.MCTSPortAuxBasques@innav.gc.ca
Website: <http://www.marinfo.gc.ca/e-nav>

* Sydney MCTS Centre

Canadian Coast Guard
1190 Westmount Road
Sydney, NS B1R 2J6

Telephone: (902) 564-7751 or 1-800-686-8676
Facsimile: (902) 564-7662

Email: NAVWARN.MCTSSydney@innav.gc.ca
Website: <http://www.marinfo.gc.ca/e-nav>

Central & Arctic Region

* Prescott MCTS Centre

Canadian Coast Guard
401 King Street West
P.O. Box 1000
Prescott, ON K0E 1T0

"C" and "Q" Series
Telephone: (613) 925-0666
Facsimile: (613) 925-4519

Email: NAVWARN.MCTSPrescott@innav.gc.ca
Website: <http://www.marinfo.gc.ca/e-nav>

* Iqaluit MCTS Centre

Operational from approximately mid-May until late December.

Canadian Coast Guard
P.O. Box 189
Iqaluit, NU X0A 0H0

"A" Series
Telephone: (867) 979-5269

"H" Series
Telephone: (867) 979-0310

Facsimile: (867) 979-4264
Email: NAVWARN.MCTSIqaluit@innav.gc.ca
Website: <http://www.marinfo.gc.ca/e-nav>

* Service available in English and French.

¹ The expression "Notice to Shipping" was changed to "Navigational Warning" in January 2019.

INDEX

SECTION 1 – GENERAL AND SAFETY INFORMATION		1
	Transport Canada – Restricted Speed Area - St. Clair and Detroit Rivers	1
	Canadian Coast Guard Publication – Comments and Suggestions on Notices to Mariners (Notmar) Publications	1
*201	Canadian Hydrographic Service – Raster Digital Charts (BSB V3)	1
*202	Canadian Coast Guard Publication – Annual Edition of Notices to Mariners 2020	1
*203	Canadian Hydrographic Service – Modifications to the 2020 Canadian Tide and Current Tables Volume 1 – Atlantic Coast and Bay of Fundy	1
*205	Port de Montréal – Daybeacons Permanently Established.....	2
*206	Taylor's Head to / à Shut-in Island – Unlit Buoy Repositioned	2
*207(P)	Havres et Mouillages - Harbours and Anchorages - Côte-Nord/North Shore – Light Buoy to be Discontinued ...	2
*208(P)	Bay D'Espoir and / et Hermitage Bay – Light Buoys to be Discontinued	3
*209(T)	Toronto Harbour – Construction Operations	4
*210	Minaki to/à Kenora – Daybeacon No Longer Reported Leaning.....	4
SECTION 2 – CHART CORRECTIONS		5
SECTION 3 – RADIO AIDS TO MARINE NAVIGATION CORRECTIONS		N/A
SECTION 4 – SAILING DIRECTIONS AND SMALL CRAFT GUIDE CORRECTIONS		19
SECTION 5 – LIST OF LIGHTS, BUOYS AND FOG SIGNALS CORRECTIONS		22

NUMERICAL INDEX OF CANADIAN CHARTS AFFECTED

Chart No.	Page	Chart No.	Page	Chart No.	Page	Chart No.	Page
1310	2	4905	17				
1320	5, 6	4921	17, 23				
2085	4	6287	4				
4002	6	6419	17				
4003	6	7011	17				
4010	6						
4020	22						
4021	6, 7						
4022	7						
4023	7						
4025	7						
4230	7						
4236	2						
4244	7, 22						
4302	7, 8, 23						
4399	8, 22						
4404	19						
4405	8, 9, 10, 23						
4406	11, 23						
4426	11						
4452	2						
4466	11, 12, 13, 14						
4485	14						
4486	14						
4644	3						
4663	14, 15						
4679	15, 16						
4680	16						
4854	16						
4855	16, 17						

TRANSPORT CANADA – RESTRICTED SPEED AREA - ST. CLAIR AND DETROIT RIVERS

(Recurrent publication of notice *1103/12, originally published in the *Notices to Mariners Publication - Eastern Edition 11/2012*.)

Since November 14, 2012, the restricted speed area currently in place as per the St. Clair and Detroit River Navigation Safety Regulations between the Detroit River light and Peche Island light is reduced in size by relocating the southern point of the restricted speed area from its current location at the Detroit River light to a new location at Bar Point light D33.

CANADIAN COAST GUARD PUBLICATION – COMMENTS AND SUGGESTIONS ON NOTICES TO MARINERS (NOTMAR) PUBLICATIONS

In an effort to continuously improve the Notices to Mariners publications and to provide the most efficient service possible, the Notices to Mariners team invites all mariners and other interested parties to submit comments and suggestions on possible improvements to its various publications and services at the following email address: Notmar.XNCR@dfo-mpo.gc.ca

***201 CANADIAN HYDROGRAPHIC SERVICE – RASTER DIGITAL CHARTS (BSB V3)**

CHARTS	MAIN TITLE	SCALE	PUBLISHED
New Editions			
RM-3493	Vancouver Harbour Western Portion/Partie Ouest	1:10 000	15-NOV-2019
RM-4622	Cape St Mary's to / à Argentia Harbour and / et Jude Island	1:80 000	20-DEC-2019

***202 CANADIAN COAST GUARD PUBLICATION – ANNUAL EDITION OF NOTICES TO MARINERS 2020**

The Annual Edition of Notices to Mariners 2020 is now available for free download, on the NOTMAR website at <https://www.notmar.gc.ca/annual-annuel-en.php>

Paper copies of this publication are no longer sold. This printable online version is kept up-to-date.

Amendments to this publication are advertised in Section 1 of the monthly editions of Notices to Mariners (<https://www.notmar.gc.ca/monthly-mensuel-en.php>).

The 2020 edition has been revised up to February 28, 2020 and supersedes the 2019 edition.

Two new notices have been added in the 2020 edition:

- Section A3: 7C – Vessels Intending to Navigate in Kitikmeot Region in Canada's Northern Waters
- Section A5: 10B – Danger Message Reporting

***203 CANADIAN HYDROGRAPHIC SERVICE – MODIFICATIONS TO THE 2020 CANADIAN TIDE AND CURRENT TABLES VOLUME 1 – ATLANTIC COAST AND BAY OF FUNDY**

The Canadian Hydrographic Service of the Atlantic Region has identified an error in the 2020 Canadian Tide and Current Tables Volume 1 - Atlantic Coast and Bay of Fundy, Tide tables for Holyrood, Newfoundland (station #925)

Mariners must refer to the following link for updated information on Holyrood's Tide Tables:

http://tides.gc.ca/eng/data/table/2020/wlev_sec/925

***205 PORT DE MONTRÉAL – DAYBEACONS PERMANENTLY ESTABLISHED**

Reference Chart: 1310

The following daybeacons have been permanently established:

Île Sainte-Marguerite starboard daybeacon	(LL 12854):	(45° 36' 14.5"N 073° 27' 53.8"W)
Île Sainte-Marguerite port daybeacon	(LL 12855):	(45° 36' 13.5"N 073° 27' 52.9"W)
Île Sainte-Marguerite port daybeacon	(LL 12856):	(45° 36' 13.6"N 073° 27' 52.7"W)
Île Sainte-Marguerite starboard daybeacon	(LL 12857):	(45° 36' 14.6"N 073° 27' 53.7"W)

(Q2019-179 to 182)

***206 TAYLORS HEAD TO / À SHUT-IN ISLAND – UNLIT BUOY REPOSITIONED**

Reference Chart: 4236

The following unlit buoy has been permanently repositioned:

Tangier buoy YJ8 (LL 5587.03): 44° 46' 56.6"N 062° 40' 34.9"W

(F2019-041)

***207(P) HAVRES ET MOUILLAGES - HARBOURS AND ANCHORAGES - CÔTE-NORD/NORTH SHORE – LIGHT BUOY TO BE DISCONTINUED**

Reference Chart: 4452

The Canadian Coast Guard proposes to permanently discontinue the following aid to navigation:

Baie Johan-Beetz light buoy C81 (LL 1582.1) (50° 16' 48.3"N 062° 48' 21.9"W)

Comments on this action are solicited from mariners and other interested parties by May 29, 2020, three months following the initial publication date of February 28, 2020. Following this date, this notice will be cancelled. Comments should be directed to the following:

Superintendent, Aids to Navigation
Canadian Coast Guard
1550 D'Estimauville Avenue
Québec, QC G1J 5E9
Telephone: (418) 648-7450
Email: Aides-Nav-Quebec.XLAU@dfo-mpo.gc.ca

Any objections raised must state the facts on which they are based and should include supporting information on safety, commerce and public benefit.

(Q2020-021)

***208(P) BAY D'ESPOIR AND / ET HERMITAGE BAY – LIGHT BUOYS TO BE DISCONTINUED**

Reference Chart: 4644

The Canadian Coast Guard proposes to permanently discontinue the following aids to navigation:

Blackfish Cove Shoal light buoy VG2	(LL 5517)	(47° 40' 10.0"N 055° 56' 00.2"W)
Gimlet Point light buoy VG3	(LL 133.3)	(47° 37' 55.1"N 055° 54' 05.3"W)
Deer Cove Shoal light buoy VG4	(LL 133.44)	(47° 40' 37.1"N 055° 55' 50.2"W)
Cold Harbour Shoal light buoy VG5	(LL 133.5)	(47° 40' 19.6"N 055° 55' 56.6"W)

Comments on this action are solicited from mariners and other interested parties by May 29, 2020, three months following the initial publication date of February 28, 2020. Following this date, this notice will be cancelled. Comments should be directed to the following:

Superintendent, Aids to Navigation
Canadian Coast Guard
P.O. Box 5667
250 Southside Road
St. John's, NL A1C 5X1
Telephone: (902) 566-7936
Email: claire.maclaren@dfo-mpo.gc.ca

Any objections raised must state the facts on which they are based and should include supporting information on safety, commerce and public benefit.

(N2020-008)

***209(T) TORONTO HARBOUR – CONSTRUCTION OPERATIONS**

Reference Chart: 2085

Construction is to take place at Ashbridge's Bay and will consist of the construction of two breakwaters. A variety of equipment will be used, including tug boats and barges. Temporary aids to navigation will be placed prior to and during construction. The operations are scheduled to take place in three phases at the following position:

43° 39' 20.7"N 079° 18' 48.1"W

Phase 1: 2020-04-01 through 2020-12-31

Phase 2: 2021-04-01 through 2021-12-31

Phase 3: 2022-04-01 through 2022-12-31

Mariners are requested to keep out of the construction zone.

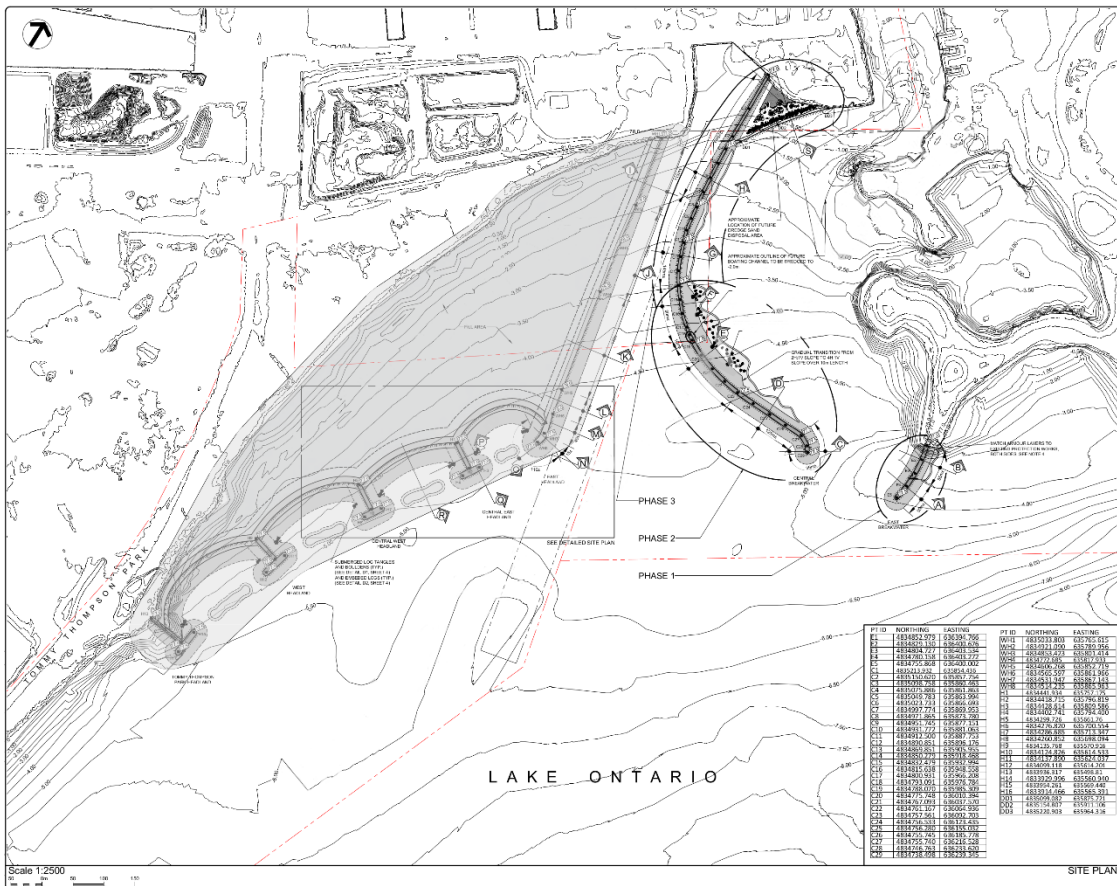

***210 MINAKI TO À KENORA – DAYBEACON NO LONGER REPORTED LEANING**

Reference: Notice 113(T)/17 is cancelled (Chart 6287).

(D2020-006)

MONTHLY NOTICES TO MARINERS
EASTERN EDITION 02/2020
SECTION 2 – CHART CORRECTIONS

1320 - Port de Gros-Cacouna - New Chart - 26-AUG-2011 - NAD 1983

21-FEB-2020

LNM/D. 29-MAR-2019

Delete	depth of 9 metres 5 decimetres (See Chart No. 1, I10) This notice affects Electronic Navigational Chart: CA579234	47°55'38.5"N 069°30'49.8"W <i>DFO(6410290-01)</i>
Add	depth of 8 metres 9 decimetres (See Chart No. 1, I10) This notice affects Electronic Navigational Chart: CA579234	47°55'39.2"N 069°30'50.6"W <i>DFO(6410290-02)</i>
Delete	depth of 8 metres 4 decimetres (See Chart No. 1, I10) This notice affects Electronic Navigational Chart: CA579234	47°55'37.6"N 069°30'51.5"W <i>DFO(6410290-03)</i>
Add	depth of 8 metres 1 decimetre (See Chart No. 1, I10) This notice affects Electronic Navigational Chart: CA579234	47°55'37.7"N 069°30'51.5"W <i>DFO(6410290-04)</i>
Add	depth of 6 metres 7 decimetres (See Chart No. 1, I10) This notice affects Electronic Navigational Chart: CA579234	47°55'45.5"N 069°31'00.6"W <i>DFO(6410290-05)</i>
Add	depth of 6 metres 5 decimetres (See Chart No. 1, I10) This notice affects Electronic Navigational Chart: CA579234	47°55'50.6"N 069°30'59.3"W <i>DFO(6410290-06)</i>
Add	depth of 5 metres 8 decimetres (See Chart No. 1, I10) This notice affects Electronic Navigational Chart: CA579234	47°55'45.0"N 069°31'12.3"W <i>DFO(6410290-07)</i>
Delete	depth of 12 metres 8 decimetres (See Chart No. 1, I10) This notice affects Electronic Navigational Chart: CA579234	47°55'50.1"N 069°31'24.8"W <i>DFO(6410290-08)</i>
Add	depth of 12 metres 4 decimetres (See Chart No. 1, I10) This notice affects Electronic Navigational Chart: CA579234	47°55'49.6"N 069°31'24.5"W <i>DFO(6410290-09)</i>
Add	depth of 6 metres 7 decimetres (See Chart No. 1, I10) This notice affects Electronic Navigational Chart: CA579234	47°55'47.5"N 069°31'12.3"W <i>DFO(6410290-10)</i>

1320 - Île du Bic au/to Cap de la Tête au Chien - New Chart - 26-AUG-2011 - NAD 1983

21-FEB-2020

LNM/D. 29-MAR-2019

Delete	pier with Ru against pier (See Chart No. 1, F14, F33) This notice affects Electronic Navigational Chart: CA379232	between 47°59'59.5"N 069°27'52.6"W and 47°59'57.6"N 069°27'50.0"W <i>DFO(6410295-01)</i>
--------	---	--

MONTHLY NOTICES TO MARINERS
EASTERN EDITION 02/2020
SECTION 2 – CHART CORRECTIONS

Add ramp 48°00'00.9"N 069°27'52.8"W
(See Chart No. 1, Ud)
This notice affects Electronic Navigational Chart: CA379232
DFO(6410295-02)

4002 - Golfe du Saint-Laurent / Gulf of St. Lawrence - New Edition - 30-OCT-2015 - NAD 1983
14-FEB-2020 LNM/D. 03-JAN-2020

Add subsurface Ocean Data Acquisition System (SADO/ODAS) with 49°03'42.0"N 061°01'24.0"W
known depth of 90 metres
(See Chart No. 1, L25)
This notice affects Electronic Navigational Chart: CA179245, CA279043
DFO(6308916-02)

Add subsurface Ocean Data Acquisition System (SADO/ODAS) with 49°11'26.4"N 058°47'14.4"W
known depth of 90 metres
(See Chart No. 1, L25)
This notice affects Electronic Navigational Chart: CA179245, CA276138
DFO(6308916-03)

4003 - Cape Breton to / à Cape Cod - New Edition - 21-MAR-2003 - NAD 1983
14-FEB-2020 LNM/D. 09-AUG-2019

Add yellow cautionary lighted spar buoy Fl(3) 2s 42°56'32.7"N 070°37'44.1"W
(See Chart No. 1, Qm)
DFO(6308914-01)

4010 - Bay of Fundy / Baie de Fundy: Inner portion / partie intérieure - New Edition - 14-FEB-2003 - NAD 1983
14-FEB-2020 LNM/D. 27-SEP-2019

Amend Oc 10s 60ft 11M to read LFl 6s57ft11M against light 45°21'59.4"N 064°23'34.2"W
(See Chart No. 1, P16)
This notice affects Electronic Navigational Chart: CA276241
(F2019044) LL(171) DFO(6308907-01)

Amend Fog Sig to read FogSig (man) against light 45°21'59.4"N 064°23'34.2"W
(See Chart No. 1, W man)
This notice affects Electronic Navigational Chart: CA276241
(F2019044) LL(171) DFO(6308907-02)

4021 - Pointe Amour à / to Cape Whittle et / and Cape George - New Edition - 01-NOV-2002 - NAD 1983
14-FEB-2020 LNM/D. 03-JAN-2020

Add depth of 12 fathoms 50°40'47.4"N 057°21'51.6"W
(See Chart No. 1, I10)
This notice affects Electronic Navigational Chart: CA276138
DFO(6308902-02)

Delete depth of 12 fathoms 50°41'27.5"N 057°22'21.9"W
(See Chart No. 1, I10)
This notice affects Electronic Navigational Chart: CA276138
DFO(6308902-03)

Add depth of 9 fathoms 50°41'32.1"N 057°22'21.0"W
(See Chart No. 1, I10)
This notice affects Electronic Navigational Chart: CA276138
DFO(6308902-04)

MONTHLY NOTICES TO MARINERS
EASTERN EDITION 02/2020
SECTION 2 – CHART CORRECTIONS

Add subsurface Ocean Data Acquisition System ODAS/SADO with 49°11'26.4"N 058°47'14.4"W
known depth of 49 fathoms
(See Chart No. 1, L25)
This notice affects Electronic Navigational Chart: CA179245, CA276138
DFO(6308916-03)

4022 - Cabot Strait and approaches / Détroit de Cabot et les approches - New Edition - 17-JAN-2003 - NAD 1983
14-FEB-2020 LNM/D. 03-JAN-2020

Add subsurface Ocean Data Acquisition System ODAS/SADO with 49°03'42.0"N 061°01'24.0"W
known depth of 49 fathoms
(See Chart No. 1, L25)
This notice affects Electronic Navigational Chart: CA179245, CA279043
DFO(6308916-02)

4023 - Northumberland Strait / Détroit de Northumberland - New Edition - 27-DEC-2002 - NAD 1983
07-FEB-2020 LNM/D. 08-NOV-2019

Amend QG to read FI G against light 46°24'22.4"N 064°08'06.4"W
(See Chart No. 1, P16)
This notice affects Electronic Navigational Chart: CA276286, CA376076
(G2019146) LL(1025.5) DFO(6308912-01)

4025 - Cap Whittle à/to Havre-Saint-Pierre et/and Île d'Anticosti - New Edition - 28-MAR-2014 - NAD 1983
14-FEB-2020 LNM/D. 12-JUL-2019

Add subsurface Ocean Data Acquisition System (SADO/ODAS) with 49°03'42.0"N 061°01'24.0"W
known depth of 90 metres
(See Chart No. 1, L25)
This notice affects Electronic Navigational Chart: CA179245, CA279043
DFO(6308916-02)

4230 - Little Hope Island to / à Cape St Marys - New Chart - 15-JUN-1990 - NAD 1983
14-FEB-2020 LNM/D. 11-OCT-2019

Amend FI 15s 30m 14M to read FI G 15s30m10M against light 43°39'45.8"N 065°52'01.0"W
(See Chart No. 1, P16)
This notice affects Electronic Navigational Chart: CA376044, CA476048
(F2019042) LL(295) DFO(6308905-01)

4244 - Wedgeport and Vicinity / et les abords - New Edition - 26-DEC-2003 - NAD 1983
14-FEB-2020 LNM/D. 01-MAR-2019

Amend FI 15s30m14M to read FI G 15s30m10M against light 43°39'45.8"N 065°52'02.6"W
(See Chart No. 1, P16)
This notice affects Electronic Navigational Chart: CA376044, CA476048
(F2019042) LL(295) DFO(6308905-01)

4302 - Canso Lock and Causeway / Écluse et Chaussée Surélevée de Canso - New Chart - 28-SEP-2012 - NAD 1983
14-FEB-2020 LNM/D. 23-AUG-2019

Amend Oc Y 6m to read Oc R 6m against light 45°38'57.7"N 061°24'59.4"W
(See Chart No. 1, P16)
This notice affects Electronic Navigational Chart: CA476678, CA576679
(G2019139) LL(701) DFO(6308899-01)

Amend Oc Y 13m to read Oc R 13m against light 45°38'53.0"N 061°24'51.8"W
(See Chart No. 1, P16)
This notice affects Electronic Navigational Chart: CA476678, CA576679
(G2019140) LL(702) DFO(6308900-01)

MONTHLY NOTICES TO MARINERS
EASTERN EDITION 02/2020
SECTION 2 – CHART CORRECTIONS

4302 - Strait of Canso - New Chart - 28-SEP-2012 - NAD 1983

14-FEB-2020		LNMD. 23-AUG-2019
Amend	Oc Y 6m 16M to read Oc R 6m16M against light (See Chart No. 1, P16) This notice affects Electronic Navigational Chart: CA476678, CA576679	45°38'57.7"N 061°24'59.4"W (G2019139) LL(701) DFO(6308899-01)
Amend	Oc Y 13m 16M to read Oc R 13m16M against light (See Chart No. 1, P16) This notice affects Electronic Navigational Chart: CA476678, CA576679	45°38'53.0"N 061°24'51.8"W (G2019140) LL(702) DFO(6308900-01)

4399 - Parrsboro Harbour and Approaches / et les approches - New Edition - 23-AUG-2002 - NAD 1983

14-FEB-2020		LNMD. 25-JUN-2010
Amend	Oc 10s 60ft 11M to read LFI 6s57ft11M against light (See Chart No. 1, P16) This notice affects Electronic Navigational Chart: CA276241	45°21'52.1"N 064°23'31.9"W (F2019044) LL(171) DFO(6308907-01)
Amend	Fog Sig 60s to read FogSig 60s (man) against light (See Chart No. 1, W man) This notice affects Electronic Navigational Chart: CA276241	45°21'52.1"N 064°23'31.9"W (F2019044) LL(171) DFO(6308907-02)

4405 - Pictou Island to / aux Tryon Shoals - New Edition - 21-FEB-2003 - NAD 1983

14-FEB-2020		LNMD. 13-SEP-2019
Delete	depth of 5 feet (See Chart No. 1, I10) This notice affects Electronic Navigational Chart: CA376161	46°06'24.9"N 063°12'24.6"W DFO(6308806-01)
Add	depth of 4 feet (See Chart No. 1, I10) This notice affects Electronic Navigational Chart: CA376161, CA476179	46°06'22.4"N 063°12'27.9"W DFO(6308806-03)
Add	depth of 5 feet (See Chart No. 1, I10) This notice affects Electronic Navigational Chart: CA376161, CA476179	46°06'38.2"N 063°12'56.4"W DFO(6308806-05)
Delete	depth of 19 feet (See Chart No. 1, I10) This notice affects Electronic Navigational Chart: CA376161	46°06'23.7"N 063°13'25.1"W DFO(6308806-06)
Add	depth of 13 feet (See Chart No. 1, I10) This notice affects Electronic Navigational Chart: CA376161, CA476179	46°06'27.4"N 063°13'23.5"W DFO(6308806-07)
Add	depth of 2 feet (See Chart No. 1, I10) This notice affects Electronic Navigational Chart: CA376161, CA476179	46°11'10.1"N 063°07'44.8"W DFO(6308806-08)

MONTHLY NOTICES TO MARINERS
EASTERN EDITION 02/2020
SECTION 2 – CHART CORRECTIONS

Add	depth of 3 feet (See Chart No. 1, I10) This notice affects Electronic Navigational Chart: CA376161	46°10'45.8"N 063°07'57.4"W <i>DFO(6308806-10)</i>
Add	depth of 5 feet (See Chart No. 1, I10) This notice affects Electronic Navigational Chart: CA376161, CA476179	46°11'20.6"N 063°04'37.9"W <i>DFO(6308806-14)</i>
Delete	depth of 14 feet (See Chart No. 1, I10) This notice affects Electronic Navigational Chart: CA376161	46°10'40.7"N 062°57'42.8"W <i>DFO(6308806-16)</i>
Add	depth of 1 foot (See Chart No. 1, I10) This notice affects Electronic Navigational Chart: CA376161, CA476179	46°10'43.1"N 062°57'49.3"W <i>DFO(6308806-17)</i>
Add	depth of 6 feet (See Chart No. 1, I10) This notice affects Electronic Navigational Chart: CA376161, CA476179	46°10'05.4"N 062°57'59.2"W <i>DFO(6308806-20)</i>
Delete	depth of 2 feet (See Chart No. 1, I10) This notice affects Electronic Navigational Chart: CA376161	46°01'05.3"N 062°54'38.6"W <i>DFO(6308807-13)</i>
Delete	depth of 3 feet (See Chart No. 1, I10) This notice affects Electronic Navigational Chart: CA376161	46°01'20.7"N 062°55'13.0"W <i>DFO(6308807-14)</i>
Add	rock awash 0 feet (See Chart No. 1, K12) This notice affects Electronic Navigational Chart: CA376161	46°01'24.2"N 062°55'19.8"W <i>DFO(6308807-15)</i>
Delete	depth of 3 feet (See Chart No. 1, I10) This notice affects Electronic Navigational Chart: CA376161	46°01'24.9"N 062°54'57.1"W <i>DFO(6308807-16)</i>
Add	drying height of 1 foot (See Chart No. 1, I15) This notice affects Electronic Navigational Chart: CA376161	46°01'19.9"N 062°55'02.1"W <i>DFO(6308807-17)</i>
Delete	depth of 7 feet (See Chart No. 1, I10) This notice affects Electronic Navigational Chart: CA376161	46°01'33.3"N 062°56'23.0"W <i>DFO(6308807-18)</i>
Add	depth of 5 feet (See Chart No. 1, I10) This notice affects Electronic Navigational Chart: CA376161	46°01'30.9"N 062°56'23.9"W <i>DFO(6308807-19)</i>

MONTHLY NOTICES TO MARINERS
EASTERN EDITION 02/2020
SECTION 2 – CHART CORRECTIONS

Add	depth of 2 feet (See Chart No. 1, I10) This notice affects Electronic Navigational Chart: CA376161	46°00'59.1"N 062°54'43.2"W <i>DFO(6308807-20)</i>
Delete	depth of 3 feet (See Chart No. 1, I10) This notice affects Electronic Navigational Chart: CA376161	46°00'53.8"N 062°54'25.5"W <i>DFO(6308807-21)</i>
Add	depth of 2 feet (See Chart No. 1, I10) This notice affects Electronic Navigational Chart: CA376161	46°00'48.5"N 062°54'29.2"W <i>DFO(6308807-22)</i>
Affix	patch Download Patch - ftp://ftp.dfo-mpo.gc.ca/patches/4405v7PA2_HillsboroughBayPatch.pdf This notice affects Electronic Navigational Chart: CA376161	46°06'15.0"N 063°00'00.0"W <i>DFO(6308807-23)</i>
Delete	light Fl (See Chart No. 1, P1) This notice affects Electronic Navigational Chart: CA376178, CA476162, CA576163 (G2019116) LL(1008.1) <i>DFO(6308860-01)</i>	46°12'48.7"N 063°29'20.0"W
Add	light Fl G (See Chart No. 1, P1) This notice affects Electronic Navigational Chart: CA376178, CA476162, CA576163 (G2019119) LL(1008.2) <i>DFO(6308863-02)</i>	46°12'42.5"N 063°29'22.9"W

4405 - Victoria Harbour - New Edition - 21-FEB-2003 - NAD 1983

14-FEB-2020		LNMD. 13-SEP-2019
Delete	light Fl (See Chart No. 1, P1) This notice affects Electronic Navigational Chart: CA376178, CA476162, CA576163 (G2019116) LL(1008.1) <i>DFO(6308860-01)</i>	46°12'50.8"N 063°29'19.7"W
Add	light Fl G (See Chart No. 1, P1) This notice affects Electronic Navigational Chart: CA376178, CA476162, CA576163 (G2019119) LL(1008.2) <i>DFO(6308863-02)</i>	46°12'44.7"N 063°29'20.3"W

4405 - Victoria Wharf / Quai - New Edition - 21-FEB-2003 - NAD 1983

14-FEB-2020		LNMD. 13-SEP-2019
Delete	light Fl (See Chart No. 1, P1) This notice affects Electronic Navigational Chart: CA376178, CA476162, CA576163 (G2019116) LL(1008.1) <i>DFO(6308860-01)</i>	46°12'50.8"N 063°29'19.7"W
Add	light Fl G (See Chart No. 1, P1) This notice affects Electronic Navigational Chart: CA376178, CA476162, CA576163 (G2019119) LL(1008.2) <i>DFO(6308863-02)</i>	46°12'44.7"N 063°29'20.3"W

MONTHLY NOTICES TO MARINERS
EASTERN EDITION 02/2020
SECTION 2 – CHART CORRECTIONS

4406 - Tryon Shoals to / à Cape Egmont - New Edition - 27-FEB-1998 - NAD 1983

07-FEB-2020		LNMD. 08-NOV-2019
Amend	QG to read FI G against light (See Chart No. 1, P16) This notice affects Electronic Navigational Chart: CA276286, CA376076	46°24'26.1"N 064°08'06.7"W (G2019146) LL(1025.5) DFO(6308912-01)
14-FEB-2020		LNMD. 07-FEB-2020
Delete	light FI (See Chart No. 1, P1) This notice affects Electronic Navigational Chart: CA376178, CA476162, CA576163	46°12'50.8"N 063°29'19.0"W (G2019116) LL(1008.1) DFO(6308860-01)
Add	pier (See Chart No. 1, F14) This notice affects Electronic Navigational Chart: CA376178	between 46°12'47.0"N 063°29'22.5"W and 46°12'44.7"N 063°29'20.3"W DFO(6308863-01)
Add	light FI G (See Chart No. 1, P1) This notice affects Electronic Navigational Chart: CA376178, CA476162, CA576163	46°12'44.7"N 063°29'20.3"W (G2019119) LL(1008.2) DFO(6308863-02)
21-FEB-2020		LNMD. 14-FEB-2020
Amend	"Channel Staked/Chenal marqué par des pieux" to read "Channel Buoyed/Chenal balisé" This notice affects Electronic Navigational Chart: CA376178	45°59'25.5"N 064°02'04.0"W DFO(6308926-01)

4426 - Dalhousie Harbour - New Edition - 02-AUG-2002 - NAD 1983

14-FEB-2020		LNMD. 12-JUL-2019
Add	depth of 26 feet (See Chart No. 1, I10)	48°04'21.4"N 066°22'44.0"W DFO(6308923-01)
Delete	depth of 28 feet (See Chart No. 1, I10)	48°04'21.2"N 066°22'42.8"W DFO(6308923-02)
Add	depth of 23 feet (See Chart No. 1, I10)	48°04'20.7"N 066°22'39.4"W DFO(6308923-03)
Add	depth of 26 feet (See Chart No. 1, I10)	48°04'21.7"N 066°22'39.7"W DFO(6308923-04)
Add	depth of 22 feet (See Chart No. 1, I10)	48°04'21.7"N 066°22'36.4"W DFO(6308923-05)

4466 - Hillsborough Bay - New Edition - 21-MAR-2003 - NAD 1983

14-FEB-2020		LNMD. 21-JUN-2019
Delete	depth of 9 feet (See Chart No. 1, I10) This notice affects Electronic Navigational Chart: CA476179	46°06'20.5"N 063°12'25.1"W DFO(6308806-02)

MONTHLY NOTICES TO MARINERS
EASTERN EDITION 02/2020
SECTION 2 – CHART CORRECTIONS

Add	depth of 4 feet (See Chart No. 1, I10) This notice affects Electronic Navigational Chart: CA376161, CA476179	46°06'22.4"N 063°12'27.9"W <i>DFO(6308806-03)</i>
Add	depth of 5 feet (See Chart No. 1, I10) This notice affects Electronic Navigational Chart: CA376161, CA476179	46°06'38.2"N 063°12'56.4"W <i>DFO(6308806-05)</i>
Add	depth of 13 feet (See Chart No. 1, I10) This notice affects Electronic Navigational Chart: CA376161, CA476179	46°06'27.4"N 063°13'23.5"W <i>DFO(6308806-07)</i>
Add	depth of 2 feet (See Chart No. 1, I10) This notice affects Electronic Navigational Chart: CA376161, CA476179	46°11'10.1"N 063°07'44.8"W <i>DFO(6308806-08)</i>
Replace	depth of 8 feet with depth of 3 feet (See Chart No. 1, I10) This notice affects Electronic Navigational Chart: CA476179	46°10'45.8"N 063°07'57.4"W <i>DFO(6308806-11)</i>
Delete	depth of 6 feet (See Chart No. 1, I10) This notice affects Electronic Navigational Chart: CA476179	46°10'12.0"N 063°08'55.0"W <i>DFO(6308806-12)</i>
Add	depth of 4 feet (See Chart No. 1, I10) This notice affects Electronic Navigational Chart: CA476179	46°10'08.8"N 063°08'52.7"W <i>DFO(6308806-13)</i>
Add	depth of 5 feet (See Chart No. 1, I10) This notice affects Electronic Navigational Chart: CA376161, CA476179	46°11'20.6"N 063°04'37.9"W <i>DFO(6308806-14)</i>
Add	depth of 2 feet (See Chart No. 1, I10) This notice affects Electronic Navigational Chart: CA476179	46°08'45.5"N 063°04'09.0"W <i>DFO(6308806-15)</i>
Add	depth of 1 foot (See Chart No. 1, I10) This notice affects Electronic Navigational Chart: CA376161, CA476179	46°10'43.1"N 062°57'49.3"W <i>DFO(6308806-17)</i>
Add	drying height of 2 feet (See Chart No. 1, I15) This notice affects Electronic Navigational Chart: CA476179	46°10'28.9"N 062°57'59.1"W <i>DFO(6308806-18)</i>
Delete	depth of 13 feet (See Chart No. 1, I10) This notice affects Electronic Navigational Chart: CA476179	46°10'08.0"N 062°57'58.8"W <i>DFO(6308806-19)</i>

MONTHLY NOTICES TO MARINERS
EASTERN EDITION 02/2020
SECTION 2 – CHART CORRECTIONS

Add	depth of 6 feet (See Chart No. 1, I10) This notice affects Electronic Navigational Chart: CA376161, CA476179	46°10'05.4"N 062°57'59.2"W <i>DFO(6308806-20)</i>
Add	depth of 12 feet (See Chart No. 1, I10) This notice affects Electronic Navigational Chart: CA476179	46°09'44.0"N 063°05'01.7"W <i>DFO(6308807-01)</i>
Replace	depth of 8 feet with depth of 4 feet (See Chart No. 1, I10) This notice affects Electronic Navigational Chart: CA476179	46°08'49.8"N 063°04'18.7"W <i>DFO(6308807-02)</i>
Add	depth of 1 foot (See Chart No. 1, I10) This notice affects Electronic Navigational Chart: CA476179	46°08'33.0"N 063°04'33.9"W <i>DFO(6308807-03)</i>
Replace	depth of 4 feet with depth of 2 feet (See Chart No. 1, I10) This notice affects Electronic Navigational Chart: CA476179	46°07'37.0"N 063°03'53.9"W <i>DFO(6308807-04)</i>
Add	depth of 10 feet (See Chart No. 1, I10) This notice affects Electronic Navigational Chart: CA476179	46°07'37.7"N 062°58'27.0"W <i>DFO(6308807-05)</i>
Add	rock awash 0 feet (See Chart No. 1, K12) This notice affects Electronic Navigational Chart: CA476179	46°07'24.2"N 062°58'11.3"W <i>DFO(6308807-06)</i>
Add	drying height of 1 foot (See Chart No. 1, I15) This notice affects Electronic Navigational Chart: CA476179	46°07'00.9"N 062°58'04.9"W <i>DFO(6308807-07)</i>
Delete	depth of 4 feet (See Chart No. 1, I10) This notice affects Electronic Navigational Chart: CA476179	46°07'10.5"N 062°54'25.0"W <i>DFO(6308807-08)</i>
Add	depth of 2 feet (See Chart No. 1, I10) This notice affects Electronic Navigational Chart: CA476179	46°07'11.5"N 062°54'21.9"W <i>DFO(6308807-09)</i>
Add	depth of 5 feet (See Chart No. 1, I10) This notice affects Electronic Navigational Chart: CA476179	46°05'40.5"N 062°57'23.6"W <i>DFO(6308807-10)</i>
Delete	depth of 9 feet (See Chart No. 1, I10) This notice affects Electronic Navigational Chart: CA476179	46°06'05.1"N 062°56'50.8"W <i>DFO(6308807-11)</i>

MONTHLY NOTICES TO MARINERS
EASTERN EDITION 02/2020
SECTION 2 – CHART CORRECTIONS

Add	depth of 5 feet (See Chart No. 1, I10) This notice affects Electronic Navigational Chart: CA476179	46°06'04.2"N 062°56'47.7"W <i>DFO(6308807-12)</i>
Affix	patch Download Patch - ftp://ftp.dfo-mpo.gc.ca/patches/4466v8PA1_PrimeTypePatch.pdf This notice affects Electronic Navigational Chart: CA476179	46°04'08.0"N 063°00'40.0"W <i>DFO(6308807-24)</i>
Affix	patch Download Patch - ftp://ftp.dfo-mpo.gc.ca/patches/4466v8PA2_PinetteHarbourPatch.pdf This notice affects Electronic Navigational Chart: CA476179	46°02'00.0"N 062°56'00.0"W <i>DFO(6308807-25)</i>
4485 - Cap des Rosiers à/to Chandler - New Edition - 17-JUN-2011 - NAD 1983		
07-FEB-2020		LNMD. 23-AUG-2019
Add	subsurface Ocean Data Acquisition System (SADO/ODAS), depth unknown (See Chart No. 1, L25) This notice affects Electronic Navigational Chart: CA379086, CA579065	48°23'20.1"N 064°29'31.7"W <i>DFO(6410205-01)</i>
4486 - Baie des Chaleurs / Chaleur Bay - New Edition - 19-FEB-1999 - NAD 1983		
07-FEB-2020		LNMD. 06-SEP-2019
Delete	depth of 4 fathoms, 2 feet (See Chart No. 1, I10) This notice affects Electronic Navigational Chart: CA376187	48°07'57.3"N 065°51'59.7"W <i>DFO(6308891-01)</i>
Add	fish haven with depth of 2 fathoms, 5 feet over an artificial feature (See Chart No. 1, K46.2) This notice affects Electronic Navigational Chart: CA376187	48°07'59.6"N 065°52'10.0"W <i>DFO(6308891-02)</i>
Add	subsurface Ocean Data Acquisition System (ODAS/SADO), depth unknown (See Chart No. 1, L25) This notice affects Electronic Navigational Chart: CA379086, CA579065	48°23'20.1"N 064°29'31.7"W <i>DFO(6410205-01)</i>
4663 - Cow Head to / à Pointe Riche - New Edition - 01-AUG-2003 - NAD 1983		
14-FEB-2020		LNMD. 27-OCT-2017
Delete	depth of 16 fathoms (See Chart No. 1, I10)	50°40'47.3"N 057°21'39.2"W <i>DFO(6308902-01)</i>
Add	depth of 12 fathoms (See Chart No. 1, I10) This notice affects Electronic Navigational Chart: CA276138	50°40'47.4"N 057°21'51.6"W <i>DFO(6308902-02)</i>
Add	depth of 9 fathoms (See Chart No. 1, I10) This notice affects Electronic Navigational Chart: CA276138	50°41'32.1"N 057°22'21.0"W <i>DFO(6308902-04)</i>

MONTHLY NOTICES TO MARINERS
EASTERN EDITION 02/2020
SECTION 2 – CHART CORRECTIONS

Delete	depth of 6 fathoms (See Chart No. 1, I10)	50°41'58.4"N 057°25'04.8"W <i>DFO(6308902-05)</i>
Delete	depth of 4 fathoms (See Chart No. 1, I10)	50°41'50.5"N 057°24'56.5"W <i>DFO(6308902-06)</i>
Add	depth of 4 fathoms (See Chart No. 1, I10)	50°41'52.7"N 057°25'07.6"W <i>DFO(6308902-08)</i>
Add	depth of 1 fathom (See Chart No. 1, I10)	50°42'07.6"N 057°25'15.0"W <i>DFO(6308902-10)</i>
Delete	depth of 12 fathoms (See Chart No. 1, I10)	50°43'20.9"N 057°23'15.9"W <i>DFO(6308902-11)</i>
Add	depth of 10 fathoms (See Chart No. 1, I10)	50°43'26.8"N 057°23'16.9"W <i>DFO(6308902-13)</i>
 4679 - Hawkes Bay, Port Saunders, Back Arm - New Edition - 29-NOV-2002 - NAD 1983		
14-FEB-2020		LNM/D. 01-NOV-2019
Add	depth of 14 fathoms (See Chart No. 1, I10)	50°39'43.5"N 057°23'59.2"W <i>DFO(6308866-01)</i>
Add	depth of 12 fathoms (See Chart No. 1, I10) This notice affects Electronic Navigational Chart: CA276138	50°40'47.4"N 057°21'51.6"W <i>DFO(6308902-02)</i>
Delete	depth of 12 fathoms (See Chart No. 1, I10) This notice affects Electronic Navigational Chart: CA276138	50°41'30.4"N 057°22'23.7"W <i>DFO(6308902-03)</i>
Add	depth of 9 fathoms (See Chart No. 1, I10) This notice affects Electronic Navigational Chart: CA276138	50°41'32.1"N 057°22'21.0"W <i>DFO(6308902-04)</i>
Add	depth of 4 fathoms, 3 feet (See Chart No. 1, I10)	50°41'52.7"N 057°25'07.6"W <i>DFO(6308902-08)</i>
Delete	depth of 3 fathoms (See Chart No. 1, I10)	50°42'07.6"N 057°25'15.0"W <i>DFO(6308902-09)</i>
Add	depth of 1 fathom (See Chart No. 1, I10)	50°42'07.6"N 057°25'15.0"W <i>DFO(6308902-10)</i>

MONTHLY NOTICES TO MARINERS
EASTERN EDITION 02/2020
SECTION 2 – CHART CORRECTIONS

Add depth of 10 fathoms 50°43'26.8"N 057°23'16.9"W
(See Chart No. 1, I10) DFO(6308902-13)

4680 - Hawkes Bay to / à Ste Geneviève Bay including / y compris St. John Bay - New Edition - 07-NOV-2003 - NAD 1983
14-FEB-2020 LNM/D. 03-OCT-2014

Add depth of 12 fathoms 50°40'47.4"N 057°21'51.6"W
(See Chart No. 1, I10)
This notice affects Electronic Navigational Chart: CA276138 DFO(6308902-02)

Delete depth of 12 fathoms 50°41'29.1"N 057°22'23.5"W
(See Chart No. 1, I10)
This notice affects Electronic Navigational Chart: CA276138 DFO(6308902-03)

Add depth of 9 fathoms 50°41'32.1"N 057°22'21.0"W
(See Chart No. 1, I10)
This notice affects Electronic Navigational Chart: CA276138 DFO(6308902-04)

Delete depth of 6 fathoms 50°41'56.2"N 057°25'08.8"W
(See Chart No. 1, I10) DFO(6308902-05)

Delete depth of 13 fathoms 50°41'50.5"N 057°25'07.4"W
(See Chart No. 1, I10) DFO(6308902-07)

Add depth of 4 fathoms 50°41'52.7"N 057°25'07.6"W
(See Chart No. 1, I10) DFO(6308902-08)

Add depth of 10 fathoms 50°43'26.8"N 057°23'16.9"W
(See Chart No. 1, I10) DFO(6308902-13)

4854 - Catalina Harbour to / à Inner Gooseberry Islands - New Chart - 25-APR-1997 - NAD 1983
21-FEB-2020 LNM/D. 28-JUL-2017

Add underwater rock of unknown depth, dangerous to surface navigation 48°32'13.2"N 053°37'57.7"W
with legend "Rep (2020)"
(See Chart No. 1, K13, I3.2)
This notice affects Electronic Navigational Chart: CA376340 DFO(6308931-01)

4855 - Bonavista Bay: Southern Portion / Partie sud - New Chart - 06-JUN-1997 - NAD 1983
14-FEB-2020 LNM/D. 06-SEP-2019

Add marina 48°40'19.6"N 054°01'22.8"W
(See Chart No. 1, F11.1)
This notice affects Electronic Navigational Chart: CA376807 DFO(6308925-01)

MONTHLY NOTICES TO MARINERS
EASTERN EDITION 02/2020
SECTION 2 – CHART CORRECTIONS

21-FEB-2020		LNMD. 14-FEB-2020
Add	underwater rock of unknown depth, dangerous to surface navigation with legend "Rep (2020)" (See Chart No. 1, K13, I3.2) This notice affects Electronic Navigational Chart: CA376340	48°32'13.2"N 053°37'57.7"W <i>DFO(6308931-01)</i>
4905 - Cape Tormentine à / to West Point - New Edition - 29-DEC-2000 - NAD 1983		
07-FEB-2020		LNM/D. 08-NOV-2019
Amend	QG to read FI G against light (See Chart No. 1, P16) This notice affects Electronic Navigational Chart: CA276286, CA376076 <i>(G2019146) LL(1025.5) DFO(6308912-01)</i>	46°24'24.7"N 064°08'04.8"W <i>DFO(6308912-01)</i>
4921 - Bonaventure - New Edition - 02-DEC-2016 - NAD 1983		
07-FEB-2020		LNM/D. 13-DEC-2019
Add	depth of 1 metre 9 decimetres (See Chart No. 1, I10)	48°02'03.0"N 065°29'14.3"W <i>DFO(6410263-01)</i>
4921 - Grande-Rivière - New Edition - 02-DEC-2016 - NAD 1983		
07-FEB-2020		LNM/D. 13-DEC-2019
Add	subsurface Ocean Data Acquisition System (SADO/ODAS), depth unknown (See Chart No. 1, L25) This notice affects Electronic Navigational Chart: CA379086, CA579065	48°23'20.1"N 064°29'31.7"W <i>DFO(6410205-01)</i>
6419 - Norman Wells to/à Carcajou Ridge Kilometre 910 / Kilomètre 980 - New Edition - 27-APR-2018 - World Geodetic System 1984		
28-FEB-2020		LNM/D. 17-MAY-2019
Reposition	red starboard hand conical buoy (See Chart No. 1, Qf)	from 65°30'39.7"N 127°40'15.7"W to 65°30'45.2"N 127°40'10.6"W <i>DFO(6604606-01)</i>
Reposition	green port hand can buoy (See Chart No. 1, Qg)	from 65°30'48.7"N 127°40'41.0"W to 65°30'54.3"N 127°40'24.4"W <i>DFO(6604606-02)</i>
7011 - Hudson Strait/Détroit D'Hudson to/à Groenland - New Edition - 02-SEP-1983 - Unknown		
21-FEB-2020		LNM/D. 11-OCT-2019
Delete	text "Rep (2019)"	62°33'30.0"N 050°26'12.0"W <i>DFO(6604609-01)</i>

MONTHLY NOTICES TO MARINERS
EASTERN EDITION 02/2020
SECTION 3 – RADIO AIDS TO MARINE NAVIGATION CORRECTIONS

NO CORRECTIONS FOR THIS SECTION.

SECTION 4 – SAILING DIRECTIONS AND SMALL CRAFT GUIDE CORRECTIONS

ATL 106 — Gulf of Maine and Bay of Fundy — Yarmouth to Minas Basin, First Edition, 2001

Chapter 2 — Paragraph 137

Delete: “A **fog signal**...horn points 250°.”

Replace by: A manually activated **fog signal** of one blast every minute is sounded close to the light; the horn points 250°. To activate: depress radio microphone switch 5 times within 10 seconds, on VHF channel 65A (156.275 MHz). The fog signal will sound for 15 minutes, and if additional signal time is required, this procedure can be repeated. The fog signal can be activated within a 1 NM distance.

(A2020-006.1)

ATL 108 — Gulf of St. Lawrence (Southwest Portion) — Northumberland Strait, First Edition, 2006

Chapter 3 — Paragraph 27 after “The harbour includes all”

Delete: “the waters of...(chart 4404).”

Replace by: navigable waters west of a line joining Roaring Bull Point (45°40'48"N, 62°34'30"W) to Logans Point (45°42'54"N, 62°38'20"W); (chart 4404).

(A2020-008.1)

ATL 110 — St. Lawrence River — Cap Whittle/Cap Gaspé to Les Escoumins and Anticosti Island, Third Edition, 2011

Chapter 1 — Paragraph 56

Delete: “Water and power outlets ... west of the commercial wharf.”

Replace by: A **marine railway** with water and power outlets is available west of the wharf.

(Q2020-001.1)

Chapter 1 — After paragraph 56.1

Add: 56.2 On the shore of Île de Kegaska, just past the commercial wharf, is an L-shaped **breakwater** reaching NW to protect the floating wharves. On the peninsula side is an imposing barge, which is permanently attached to the shore in the direction of the breakwater. A private warning **light** is fixed to one end of the barge. The navigable channel between the two structures is less than 30 m wide. **Caution** is required to prevent damage to vessels when passing through the channel.

(Q2020-001.2)

Chapter 1 — Adjacent to paragraph 56.2, add a caution pictograph.

(Q2020-001.3)

Chapter 1 — In the vicinity of paragraphs 48 and 56

Replace the **KEGASKA (2009)** photograph with the photograph **KEGASKA (2018)**.

https://www.notmar.gc.ca/publications/monthly-mensuel/images/ed0220-sec4-atl110-KEGASKA_2018.jpg

(Q2020-001.4)

ATL 111 — St. Lawrence River — Île Verte to Québec and Fjord du Saguenay, Third Edition, 2007

Chapter 4 — Paragraph 64

Delete: “There is a landing pier and **floating docks**.”

(Q2020-002.1)

SECTION 4 – SAILING DIRECTIONS AND SMALL CRAFT GUIDE CORRECTIONS

ATL 112 — St. Lawrence River — Cap-Rouge to Montreal and Richelieu River, Third Edition, 2009

Chapter 3 — Paragraph 33, after “on the ferry and the river banks.”

Add: There is a **wreck** at the bottom of the river, on the west side,
approximately 0.6 miles north of the Coderre Stream.

(Q2019-073.1)

CEN 305 — Lake Huron, St. Marys River, Lake Superior, 2000 —

Chapter 1 — Paragraph 204

Delete: 132 feet (40 m)

Replace by: 58 m

(C2020-002.01)

Chapter 1 — Paragraph 204, after ‘...(40 m) high...’

Delete: *(not shown on the chart)*

(C2020-001.02)

Chapter 1 — Paragraph 204, after ‘...prominent flagpole...’

Delete: *(not shown on the chart)*

(C2020-001.03)

Chapter 1 — Paragraph 248, after ‘...(0.3 to 1.5 m) (1995)’

Insert: was in ruins in 2019.

(C2020-001.04)

Chapter 1 — Paragraph 282

Delete: **Woman**

Replace by: **Woman’s**

(C2020-001.05)

Chapter 1 — Paragraph 283

Delete: **Woman**

Replace by: **Woman’s**

(C2020-001.06)

INDEX — After Old Woman Bay, C4/P152

Delete: Old Woman River, C1/P282

Replace by: Old Woman’s River, C1/P282

(C2020-001.07)

CEN 308 — Rideau Canal and Ottawa River, First Edition, 2003

Chapter 9 — Paragraph 134, after “clearance of”

Delete: 6.2 m

Replace by: 6.0 m

(Q2019-025.1)

Chapter 9 — Paragraph 136, after “clearance of”

Delete: 6.7 m

Replace by: 6.0 m

(Q2019-025.2)

SECTION 4 – SAILING DIRECTIONS AND SMALL CRAFT GUIDE CORRECTIONS

Chapter 9 — Delete paragraph 141.

(Q2019-025.3)

Chapter 9 — Paragraph 142, after “a clearance of 8.5 m..”

Delete: “An area for water-skiing ... in Saraguay.”

(Q2019-025.4)

APPENDIX — **Table of marine facilities*** — CHAPTER 9

Delete all information pertaining to Marina de Pierrefonds.

(Q2019-025.5)

MONTHLY NOTICES TO MARINERS
EASTERN EDITION 02/2020

SECTION 5 – LIST OF LIGHTS, BUOYS AND FOG SIGNALS CORRECTIONS

The amendments are highlighted and deletions are crossed out. For general and region-specific information on the List of Lights, click on the following links: [Newfoundland and Labrador Coast](#), [Atlantic Coast](#), [Inland Waters](#) and [Pacific Coast](#).

No.	Name	Position ----- Latitude N. Longitude W.	Light Characteristics	Focal Height in m. above water	Nomi- nal Range	Description ----- Height in meters above ground	Remarks ----- Fog Signals
-----	------	--	--------------------------	--	-----------------------	--	---------------------------------

NEWFOUNDLAND AND LABRADOR COAST

STRAIT OF BELLE ISLE (LL 211 – 234)

230.5 228.3	L'Anse-au-Diable light buoy ND2	At entrance. 51 33 25.2 056 45 35.5	Fl R 4s	Red spar, marked "ND2".	Seasonal. Chart:4020 Edn 02/20 (N20-003)
230.35 228.4	L'Anse-au-Diable light buoy ND1	At entrance. 51 33 25.1 056 45 39.9	Fl G 4s	Green spar, marked "ND1".	Seasonal. Chart:N/A Edn 02/20 (N20-002)

ATLANTIC COAST

BAY OF FUNDY, N.S. (LL 163 – 268)

171 H3950	Cape Sharp	On S. extremity of cape. 45 21 52.2 064 23 31.5	LFl W 6s	17.4	11	White pyramid tower with red top. 11.7	Flash 2 s; eclipse 4 s. Operates 24 h. Year round. Horn - Blast 4 s; sil. 56 s. Horn points 250°. Mariners requiring the operation of the fog signal will have to select VHF channel 65 and key their microphones five (5) times within 10 seconds. The fog signal will be in operation for 15 minutes. The fog signal can be activated within a 1 NM distance. The fog signal can be activated for another 15 minutes by repeating the above procedure. Chart:4399 Edn 02/20 (F19-044)
--------------	------------	--	----------	------	----	--	--

NOVA SCOTIA, SOUTHWEST COAST (LL 271 – 300.5)

295 H3800	Whitehead Island	On S. point of island. 43 39 45.8 065 52 02.6	Fl G 15s	30.0	10	Red and white rectangular tower with red top. connected to white square building with cylindrical mast on roof of building. 11.9	Flash 1 s; eclipse 14 s. Year round. Horn - Blast 3 s; sil. 27 s. Omnidirectional. Chart:4244 Edn 02/20 (F19-042)
--------------	------------------	--	----------	------	----	---	--

MONTHLY NOTICES TO MARINERS
EASTERN EDITION 02/2020

SECTION 5 – LIST OF LIGHTS, BUOYS AND FOG SIGNALS CORRECTIONS

No.	Name	Position ----- Latitude N. Longitude W.	Light Characteristics	Focal Height in m. above water	Nomi- nal Range	Description ----- Height in meters above ground	Remarks ----- Fog Signals
-----	------	--	--------------------------	--	-----------------------	--	---------------------------------

NOVA SCOTIA AND CAPE BRETON ISLAND (LL 686.5 – 704.1)

701 H3436	Balache Point range	N. end of Canso Lock. 45 38 57.7 061 24 59.4	Oc R 11s	6.0	Square skeleton tower, white trapezoidal daymark with red vertical stripe. 3.5	Flash 10 s; eclipse 1 s. Visible in line of range. Operates 24 h. Seasonal.
702 H3436.1		131°30' 219.84 m from front.	Oc R 11s	13.0	White square tower, red upper portion, red vertical stripe. 7.5	Flash 10 s; eclipse 1 s. Visible in line of range. Operates 24 h. Seasonal.

Chart:4302
Edn 02/20 (G19-139, 140, 141)

GULF OF ST. LAWRENCE (LL 883.2 – 940.3, 1169.1 – 1426, 1477.5 – 1584)

1373.3 H1665	Paspébiac Breakwater	On outer end of breakwater. 48 01 06.1 065 15 34.3	Fl G 6s	10.7	7	Square skeleton tower. 8.1	Flash 1 s; eclipse 5 s. Operates at night only. Year round.
1374 H1666	Paspébiac Wharf	On W. end of wharf. 48 01 08.0 065 15 29.1	Fl R 6s	9.6	6	Pipe swing pole. 6.5	Flash 1 s; eclipse 5 s. Omnidirectional. Year round.

Chart:4921
Edn 02/20 (Q20-002)

Chart:4921
Edn 02/20 (Q20-003)

PRINCE EDWARD ISLAND (LL 942 – 1084.7)

1008.1 H1036	Victoria Harbour						Delete from list.
1008.2	Victoria Harbour Wharf light	46 12 44.7 063 29 20.3	Fl G 4s	6	Pipe swing pole, green- white-black square daymark.	Flash 1 s; eclipse 3 s. Seasonal.
1025.5 H1057.5	Fishing Cove West Breakwater	On S. end of W. breakwater. 46 24 26.1 064 08 06.7	Fl G 4s	3.2	4	Cylindrical mast. 2.8	Flash 1 s; eclipse 3 s. Operates at night only. Seasonal.
1046.06	St. Peters Harbour light buoy JD12	46 26 44.4 062 44 16.0	Fl R 4s	Red, marked "JD12".	Buoy may be repositioned due to shifting channel. Seasonal.

Chart:4405
Edn 02/20 (G19-116)

Chart:4405
Edn 02/20 (G19-119)

Chart:4406
Edn 02/20 (G19-146)

Chart:N/A
Edn 02/20 (G19-135)

CANADIAN COAST GUARD – MARINE INFORMATION REPORT AND SUGGESTION SHEET

Name of Ship or Sender: Date:

Address of Sender:
Street # Street Name

Town / City: Prov / State: Postal Code / Zip Code:

Tel / Fax / E-mail address of sender:

Observation Date: Time (UTC):

Geographical Position:

Coordinate Position: Lat: Long:

Position Method: DGPS GPS with WAAS GPS Radar Other

Horizontal Datum Used: WGS 84 NAD 27 Other

Estimated Position Accuracy:

Chart #: Datum: NAD 27 NAD 83

Chart Edition: Last Correction applied:

Publications affected (Quote edition and page number):

*Full details (Attach additional sheets as necessary):

Mariners are requested to notify the responsible authorities when new or suspected dangers to navigation are discovered, changes are observed in aids to navigation, or corrections to publications are seen to be necessary.

In the case of new or suspected dangers to navigation, it is important that all details be given in order to aid with future investigations. Items of interest include heights, depths, physical description, type of bottom and equipment method used to position the item. It is helpful to mark details on the chart, which will be promptly replaced by the Canadian Hydrographic Service.

Reports should be made to the nearest Marine Communications and Traffic Services Centre (MCTS) and should be confirmed in writing to:

Leader, Notices to Mariners
Canadian Coast Guard
Department of Fisheries and Oceans
Montreal, QC H2Y 2E7
Notmar.XNCR@dfo-mpo.gc.ca

In the case of information concerning aids to navigation or the List of Lights, Buoys and Fog Signals book.

OR

Director General, Canadian Hydrographic Service &
Oceanographic Services
Department of Fisheries and Oceans
Ottawa, ON K1A 0E6
CHSINFO@dfo-mpo.gc.ca

In the case of new or suspected dangers to navigation or where corrections to "Sailing Directions" appear to be necessary.

For general questions on Canadian Coast Guard programs or services, please send an e-mail to:
info@dfo-mpo.gc.ca